

DIN 125 Arandela
Washer

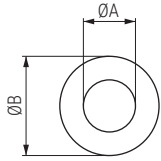

| ØA | ØB | | Zincado | | Acero inox |
|----|----|-------|-------------|-------|-----------------|
| | | | Zinc plated | | Stainless steel |
| | | | CÓDIGO CODE | | CÓDIGO CODE |
| 4 | 9 | 1.000 | 861.83 | 1.000 | 9006.35 |
| 5 | 10 | 1.000 | 861.82 | 1.000 | 9006.36 |
| 6 | 12 | 1.000 | 861.43 | 1.000 | 9006.37 |
| 7 | 14 | 1.000 | 861.44 | | |
| 8 | 16 | 500 | 861.45 | 500 | 9006.38 |
| 10 | 20 | 450 | 861.46 | 500 | 9006.39 |
| 12 | 24 | 500 | 861.47 | 200 | 9006.40 |

DIN 9021 Arandela
Washer

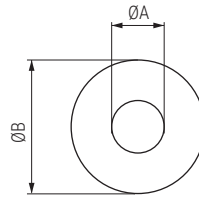

| ØA | ØB | | Zincado | | Acero inox |
|----|----|-------|-------------|-------|-----------------|
| | | | Zinc plated | | Stainless steel |
| | | | CÓDIGO CODE | | CÓDIGO CODE |
| 4 | 12 | 2.000 | 861.32 | 1.000 | 9006.96 |
| 5 | 15 | 2.000 | 861.33 | 500 | 9006.116 |
| 6 | 18 | 1.000 | 861.34 | 1.000 | 9006.117 |
| 7 | 22 | 1.000 | 861.42 | | |
| 8 | 25 | 250 | 861.35 | 500 | 9006.84 |
| 10 | 30 | 200 | 861.36 | 200 | 9006.118 |
| 12 | 40 | 300 | 861.37 | 200 | 9006.120 |

Estándar Arandela
Washer

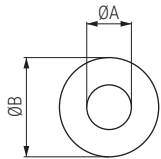

| Código Code | ØA | ØB | Material | Acabado Finish | |
|-------------|----|------|-------------|----------------|-------|
| 861.57 | 7 | 16 | acero/steel | zincado/zinc | 500 |
| 861.58 | 8 | 18 | acero/steel | zincado/zinc | 500 |
| 861.60 | 10 | 22,5 | acero/steel | zincado/zinc | 1.000 |
| 861.61 | 12 | 22 | acero/steel | zincado/zinc | 500 |

AFT Arandela
Washer



| Código Code | Ø | Material | Acabado Finish | |
|-------------|------|-------------|--------------------------|-------|
| 365.2 | 6 | acero/steel | zincado negro/black zinc | 1.000 |
| 365.3 | 8 | acero/steel | zincado negro/black zinc | 1.000 |
| 365.272 | 10,5 | acero/steel | zincado negro/black zinc | 1.000 |

Grower DIN 127 Arandela
Washer

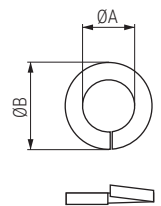

| ØA | ØB | | ZINCADO | | Acero inox |
|----|----|-------|-------------|-------|-----------------|
| | | | ZINC | | Stainless steel |
| | | | CÓDIGO CODE | | CÓDIGO CODE |
| 6 | 11 | 1.000 | 361.32 | 1.000 | 9006.113 |
| 8 | 14 | 1.000 | 361.33 | 1.000 | 9006.114 |
| 10 | 17 | 600 | 361.34 | 100 | 9006.75 |

DIN 6797-J MIKALOR Arandela dentada
Washer

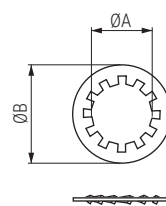

| Código Code | ØA | ØB | Material | Acabado Finish | |
|-------------|------|------|-------------|--------------------------|-------|
| 365.308 | 6,4 | 11 | acero/steel | zincado negro/black zinc | 2.500 |
| 365.309 | 8,2 | 15 | acero/steel | zincado/zinc | 1.000 |
| 365.310 | 10,5 | 18 | acero/steel | zincado/zinc | 1.000 |
| 365.311V | 13 | 20,5 | acero/steel | zincado/zinc | 500 |