

1 Bisagras y sistemas de apertura

Hinges and opening systems

Bases DOMI de enganche rápido clip
Regulación **frontal y vertical** mediante excéntrica
• Para bisagras Serie 100, 200, B y Silentia+.

Base DOMI recta modelo **BAP3M**



ACTUALIZADO EL DÍA 20/01/2026

| CÓDIGO | REFERENCIA | Altura | Material | Acabado | |
|--------|------------|--------|----------|---------|-----|
| 30.539 | BAP3M09 | H0 | acero | níquel | 300 |
| 30.540 | BAP3M29 | H2 | acero | níquel | 300 |
| 30.541 | BAP3M39 | H3 | acero | níquel | 300 |

Base DOMI recta modelo **BAP7M**

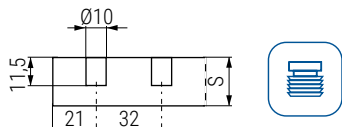

| CÓDIGO | REFERENCIA | Altura | Material | Acabado | |
|---------|------------|--------|----------|---------|-----|
| 30.536 | BAP7M09 | H0 | acero | níquel | 300 |
| 30.537V | BAP7M29 | H2 | acero | níquel | 300 |
| 30.538 | BAP7M39 | H3 | acero | níquel | 300 |

Base DOMI recta modelo **BAP3R**



ACTUALIZADO EL DÍA 20/01/2026

| CÓDIGO | | REFERENCIA | Altura | Material | |
|--------|---------|------------|--------|----------|-----|
| Níquel | Titanio | | | | |
| 30.501 | 30.401 | BAP3R09/06 | H0 | zamak | 300 |
| 30.502 | 30.402 | BAP3R39/36 | H3 | zamak | 300 |
| 30.503 | 30.403 | BAP3R69/66 | H6 | zamak | 300 |

Base DOMI recta modelo **BAPGR**

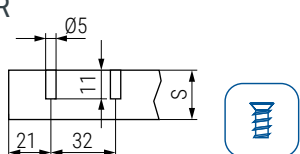

| CÓDIGO | REFERENCIA | Altura | Material | Acabado | |
|--------|------------|--------|----------|---------|-----|
| 30.564 | BAPGR09/16 | H0 | zamak | níquel | 300 |
| 30.565 | BAPGR39/16 | H3 | zamak | níquel | 300 |

Base DOMI recta modelo **BAP7R**

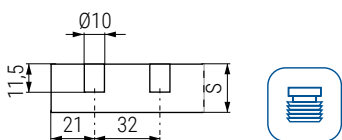

| CÓDIGO | REFERENCIA | Altura | Material | Acabado | |
|--------|------------|--------|----------|---------|-----|
| 30.566 | BAP7R09 | H0 | zamak | níquel | 300 |
| 30.567 | BAP7R39 | H3 | zamak | níquel | 300 |

Base DOMI recta modelo **BAGHR**

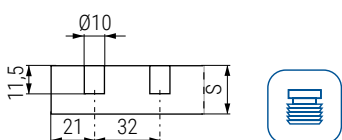

| CÓDIGO | REFERENCIA | Altura | Material | Acabado | |
|--------|------------|--------|----------|---------|-----|
| 30.535 | BAGHR59 | H5 | zamak | níquel | 300 |

Bases DOMI de enganche rápido clip
Regulación **frontal y vertical** mediante excéntrica
• Para bisagras Serie 100, 200, B y Silentia.

Base DOMI avión modelo **BAR3R**

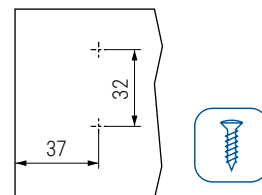

| CÓDIGO | | REFERENCIA | Altura | Material | |
|--------|---------|------------|--------|----------|-----|
| Níquel | Titanio | | | | |
| 30.506 | 30.406 | BAR3R09/06 | H0 | zamak | 300 |
| 30.507 | 30.407 | BAR3R39/36 | H3 | zamak | 300 |
| 30.508 | 30.408 | BAR3R69/66 | H6 | zamak | 300 |
| 30.509 | | BAR3R99 | H9 | zamak | 300 |

Base DOMI avión modelo **BAR3L**

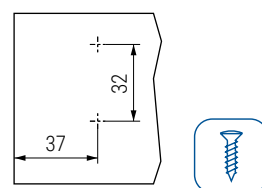

| CÓDIGO | REFERENCIA | Altura | Material | Acabado | |
|---------|------------|--------|----------|---------|-----|
| 30.129 | BAR3L09F | H0 | acero | níquel | 300 |
| 30.133V | BAR3L39F | H3 | acero | níquel | 300 |

Base DOMI avión modelo **BARGR**

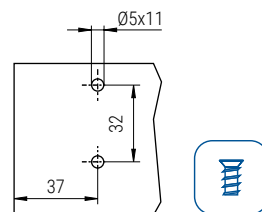

ACTUALIZADO EL DÍA 22/05/2024

| CÓDIGO | REFERENCIA | Altura | Material | Acabado | |
|--------|------------|--------|----------|---------|-----|
| 30.571 | BARGR09 | H0 | zamak | níquel | 300 |
| 30.572 | BARGR39/16 | H3 | zamak | níquel | 300 |

Base DOMI avión modelo **BAR4R**

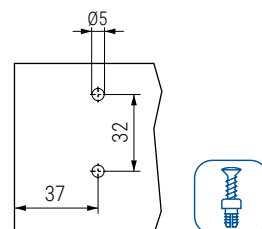

| CÓDIGO | REFERENCIA | Altura | Material | Acabado | |
|--------|------------|--------|----------|---------|-----|
| 30.512 | BAR4R09/16 | H0 | zamak | níquel | 300 |
| 30.513 | BAR4R39/16 | H3 | zamak | níquel | 300 |
| 30.514 | BAR4R69/16 | H6 | zamak | níquel | 300 |

Base DOMI avión modelo **BAR7R**

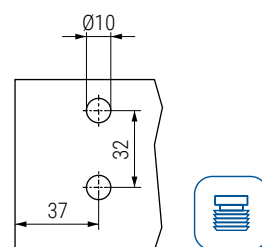

| CÓDIGO | REFERENCIA | Altura | Material | Acabado | |
|--------|------------|--------|----------|---------|-----|
| 30.515 | BAR7R39 | H3 | zamak | níquel | 300 |