

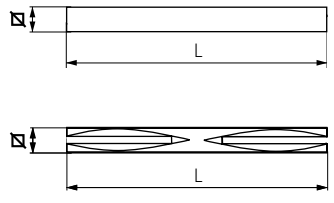

### CUADRADILLO Cuadradillo de acero para manivela

Steel square for crank handle





TIPO 1  
TIPO 2

Código Code	TIPO	∅	L	Material	Acabado Finish	
11.54	1	6	78	acero/steel	bruto/rough	1/20
11.53	1	8	60	acero/steel	bruto/rough	1/20
11.55	2	8	80	acero/steel	bruto/rough	1/20
11.65	2	8	90	acero/steel	bruto/rough	1/20

### CUADRADILLO Cuadradillo de expansión 8x8x55

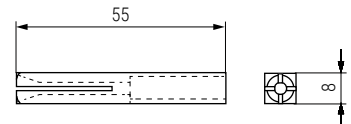
Expansion spindle 8x8x55



Código Code	Material	Acabado Finish	
11.66	acero/steel	zincado/zinc	1/20

### CUADRADILLO Cuadradillo de expansión 8x8x85

Expansion spindle 8x8x85

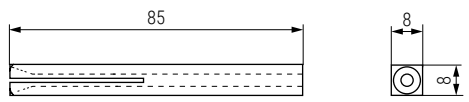

Código Code	Material	Acabado Finish	
700.213	acero/steel	zincado/zinc	1